

ISO 6431

VDMA SİLİNDİR / VDMA CYLINDER

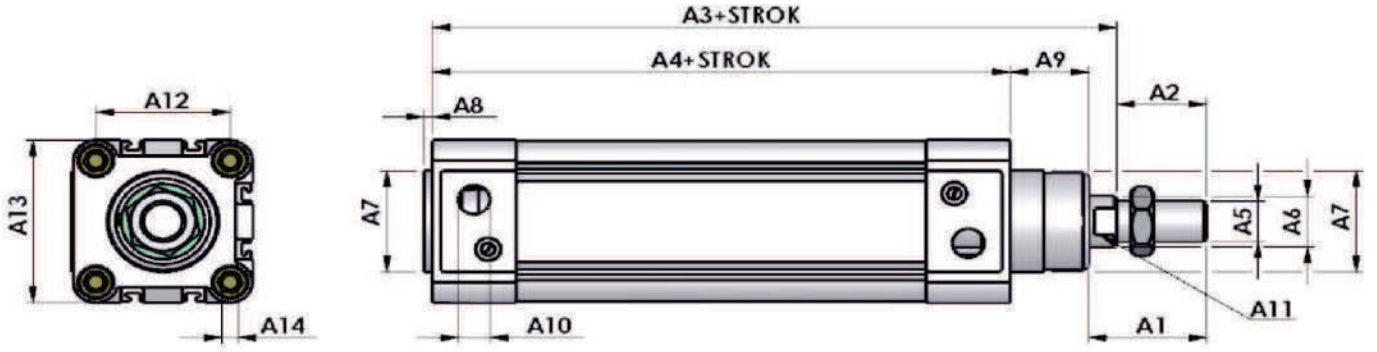

ÇİFT MİLLİ VDMA SİLİNDİR / DOUBLE ROD VDMA CYLINDER

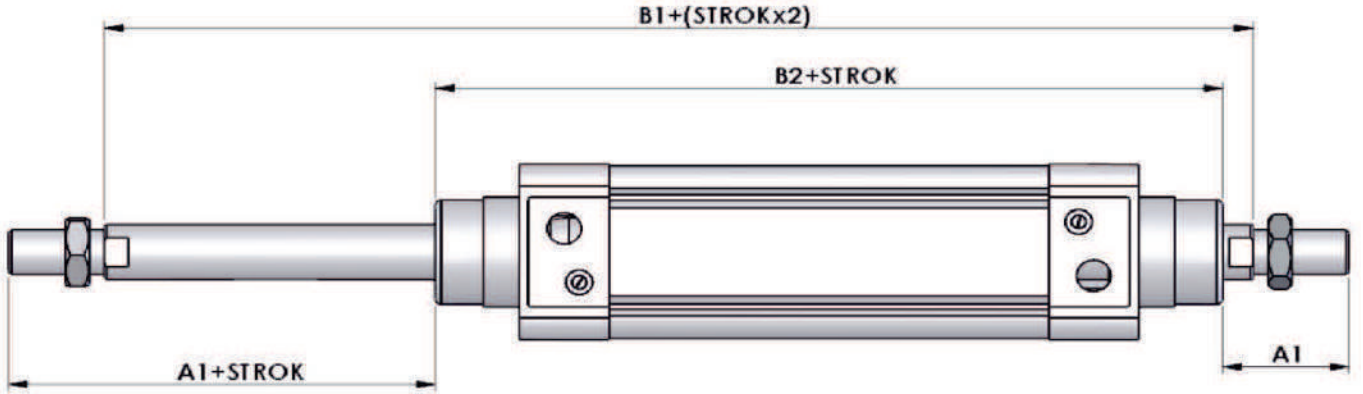

Ø	A1	A2	A3	A4	A5	A6	A7	A8	A9	A10	A11	A12	A13	A14	B1	B2
32	30	22	120	94	M10X1,25	12	30	4	18	1/8	10	32.5	45	M6	146	130
40	34	24	137	105	M12X1,25	16	35	4	22	1/4	14	38	53	M6	168	148
50	42	32	144	106	M16X1,5	20	40	4	28	1/4	17	46.5	63	M8	181	161
63	42	32	159	121	M16X1,5	20	44	4	28	3/8	17	56.5	74	M8	197	177
80	58	44	179	130	M20X1,5	25	45	5	34	3/8	22	72	82	M10	228	200
100	58	44	190	138	M20X1,5	25	55	6	38	1/2	22	89	109	M10	242	214
125	73	54	200	160	M27x2	32	60	7	40	1/2	27	110	145	M12	278	240

ISO 6431

H YATAKLI SİLİNDİR (HY) / H GUIDE CYLINDER (HG)

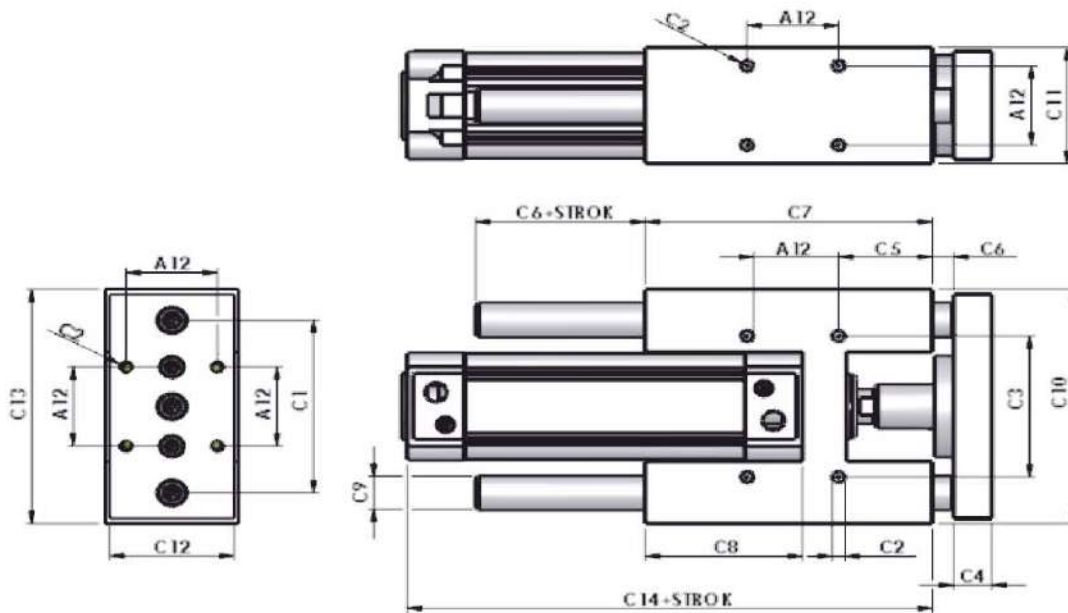

Ø	C1	C2	C3	C4	C5	C6	C7	C8	C9	C10	C11	C12	C13	C14
32	74	M6	61	15	34	5	115	67	12	99	50	45	95	151
40	87	M6	69	15	43	5	134	77	16	119	56	50	115	161
50	104	M8	85	20	49	5	150	82	20	141	70	65	135	172.5
63	119	M8	100	20	55	5	170	96	20	156	80	75	150	195

U YATAKLI SİLİNDİR (UY) / U GUIDE CYLINDER (SSC)

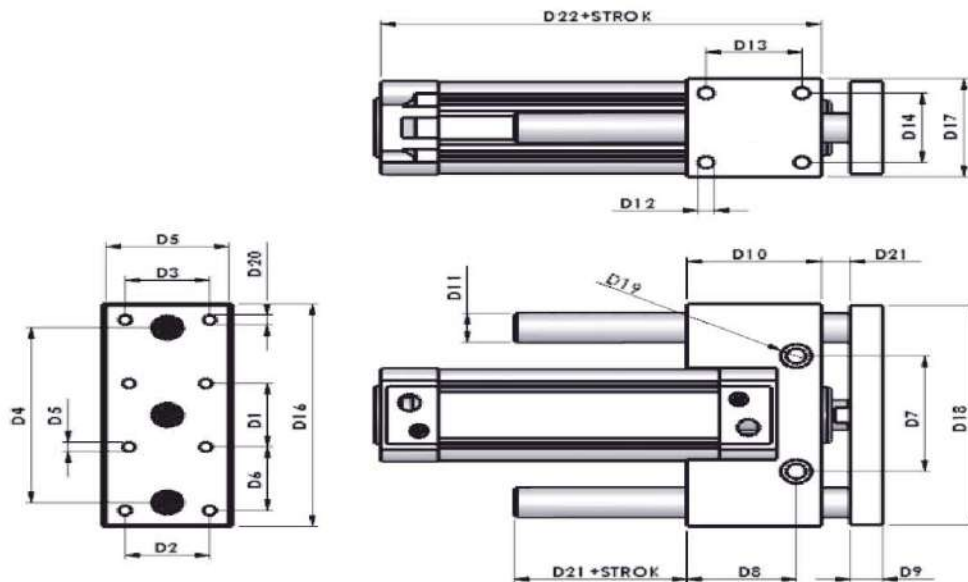

Ø	D1	D2	D3	D4	D5	D6	D7	D8	D9	D10	D11	D12	D13	D14	D15	D16	D17	D18	D19	D20	D21	D22
32	40	22	30	90	M8	32	56	44	15	55	16	M8	35	32	40.5	##	47	120	Ø13.5X8,5-Ø8,5	M6	5	114
40	40	32	32	96	M8	32	64	46	15	58	16	M8	38	40	49	##	55	124	Ø13.5X8,5-Ø8,5	M8	5	126
50	44	44	44	121	M8	44	80	57	17	70	20	M10	50	48	64	##	68	156	Ø16.5X10,5-Ø10,5	M8	5	130
63	46	58	58	130	M8	47	88	62	17	75	20	M10	55	60	78	##	80	164	Ø16.5X10,5-Ø10,5	M8	5	152

ISO 6431

ÇATAL BAĞLANTI (ÇB) / ROD CLEVIS (RC)

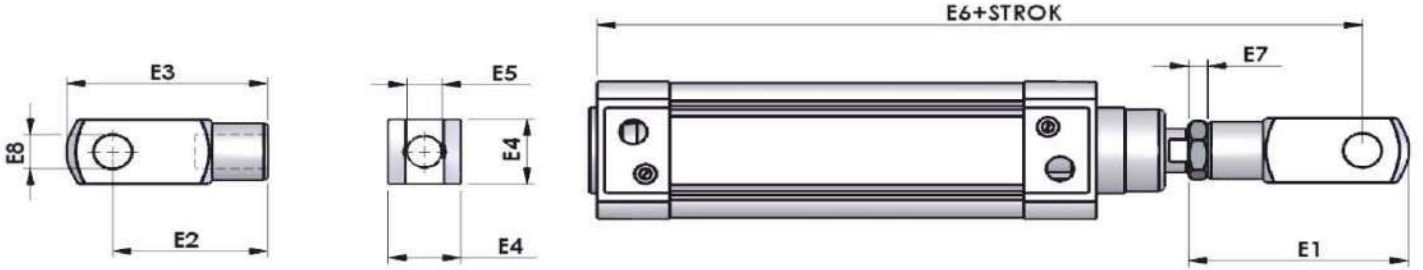

EKLEM BAĞLANTI (EB) / SWIVEL FLANGE (SF)

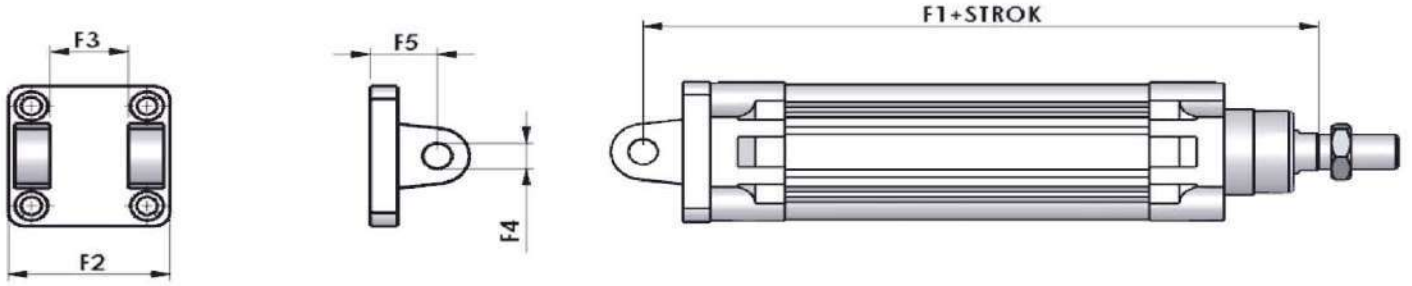

EKLEM YER BAĞLANTI (EYB) / SWIVEL FLANGE WITH FOOT MOUNTING (SFWFM)

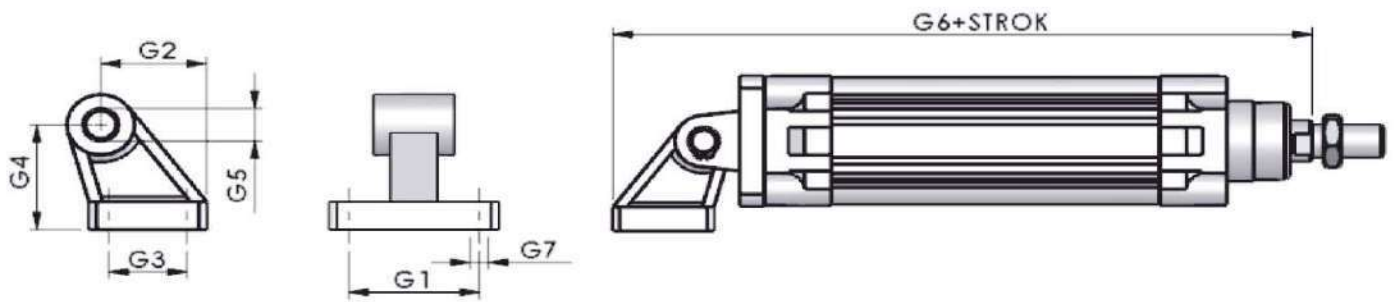

Ø	E1	E2	E3	E4	E5	E6	E7	E8	F1	F2	F3	F4	F5	G1	G2	G3	G4	G5	G6	G7
32	59	40	53	20	10	170	6	10	145	45	26	10	22	38	27.5	18	32	10	161	5.5
40	70	47	63	24	12	193	7	12	161,5	54	27.5	12	24.5	41	30.5	22	36	12	182,5	6
50	91	62	83	30	16	217	8	16	171	65	31.5	12	27	50	40.5	30	45	12	197	7
63	91	64	83	30	16	233	8	16	195,5	75	39	16	34.5	52	44.5	35	50	16	221,5	7
80	113.5	80	105	40	20	265,5	8.5	20	215	96	50	16	38	66	57	40	63	16	246	9
100	113.5	80	105	40	20	278,5	8.5	20	233	115	60	20	43	76	65	50	71	20	267	9
125	145	100	132	50	25	313	13	25	255.5	145	71	25	55.5	93	85	60	90	25	285	11

ISO 6431

FLANŞ BAĞLANTI (FB) / FLANGE MOUNTING (MF)

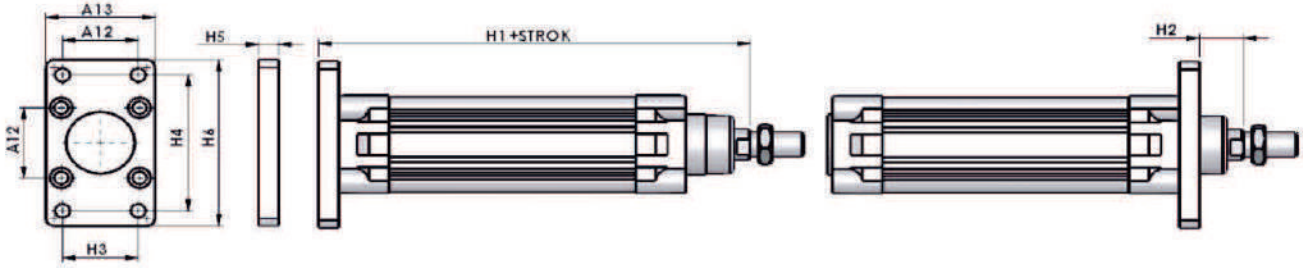

AYAK BAĞLANTI (AB) / FOOT MOUNTING (FM)

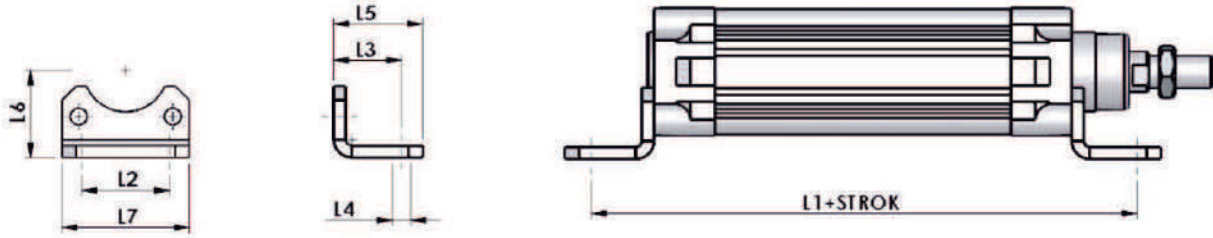

Ø	H1	H2	H3	H4	H5	H6	H7	L1	L2	L3	L4	L5	L6	L7
32	140	16	32	64	10	161	7	143	32	23	7	33	31.3	45
40	143	21	36	72	10	182,5	9	160	36	27	9	36	33.5	55
50	148.5	26	45	90	12	197	9	173,5	43.5	33,5	9	44	50.3	63
63	172	26	50	102.5	15	221,5	9	190	50	33,5	9	50	50	80
80	194.5	31	53	126	18	246	12	202	62	37	12	56	64	95
100	208.5	34	75	150	18	267	14	220	75	41	14	56	71	123
125	180	20	90	180	20	210	16	260	90	50	16	69	92	145

ISO 6431
VDMA 24562-1

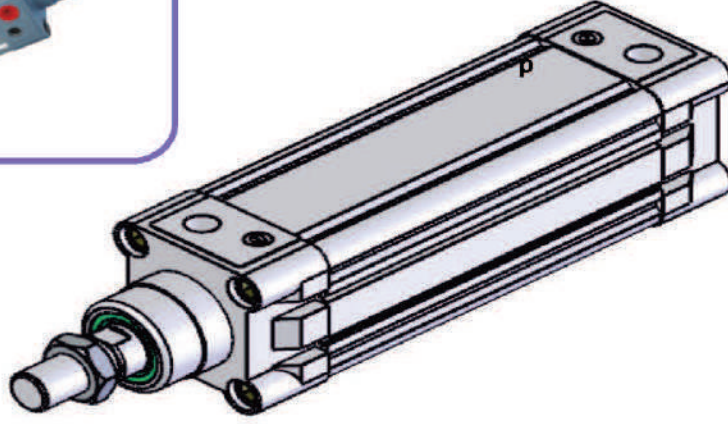
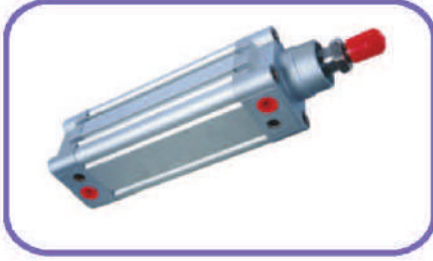

TEKMAK VDMA SİLİNDİR

Ø32-Ø100 (TITS)

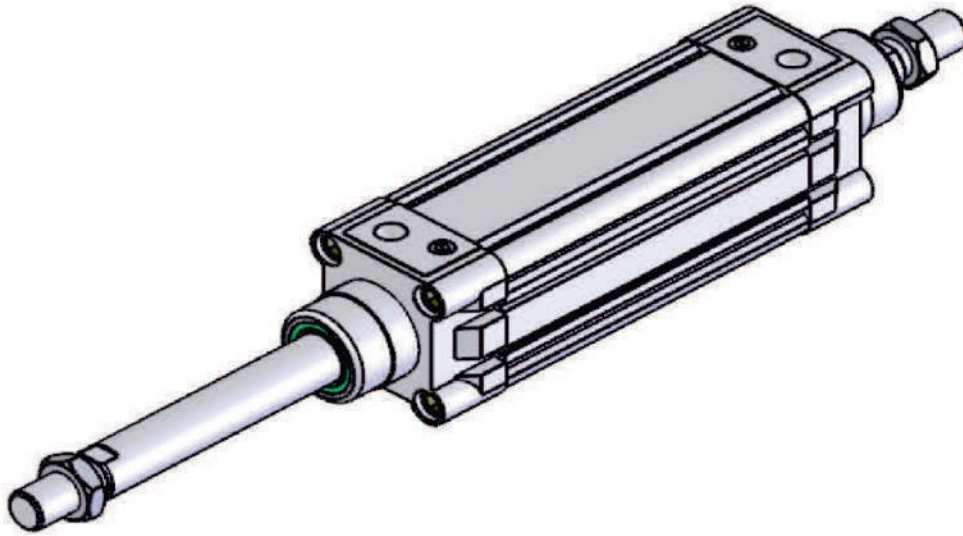

TEKMAK ÇİFT MİLLİ VDMA SİLİNDİR

Ø32-Ø100 (TCITS)

Sipariş nasıl verilir ? / How to Order ?

Model Silindir Çapı Strok / Model Cylinder Diameter Strok

TITS 032 050 EYB

TITS - 080 - 050 - EYB

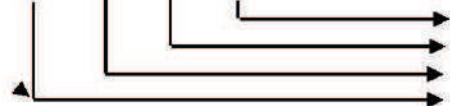

Yardımcı ekipman / Auxiliary equipment
Strok / Stroke
Silindir çapı / Cylinder diameter
Model / Model

ISO 6431

TEKNİK ÖZELLİKLER

Çalışma Ortamı	: Filtrelenmiş sıkıştırılmış hava
Çalışma sıcaklığı	: -20 / +70°C
Çalışma basıncı min.	: 0.1 Mpa-Tek etkili:0.3 Mpa
Çalışma basıncı max.	: 1.0 Mpa
Uygulanabilir hız	: 500 mm/s
Yağlama	: Önemsiz
Strok hatası	: ±0.3 mm
Hareket tipi	: Çift etkili
Mil	: CK-45 sert krom kaplı
Boru	: ALMGSG05
Sızdırmazlık	: Poliüreten+NBR
Manyetik güç	: T-32R

İSTEĞE BAĞLI ÖZELLİKLER

Aşırı sıcak ortamlar için özel
Tek etkili (yay dönüşlü)
Strok ayarlı
Mil ölçüsü değişebilir
Silindir mili paslanmaz olarak üretilebilir

SİLİNDİR MODELLERİ

TITS	: VDMA silindir
TCITS	: Çift milli VDMA silindir
TTITS	: Tandem VDMA silindir
TÖITS	: Özel VDMA silindir

STANDART BORU ÇAPLARI

Ø32	Ø50	Ø80
Ø40	Ø63	Ø100

STANDART STROKLAR

50	100	160	200	250
----	-----	-----	-----	-----

TECNICAL PROPERTIES

Operating enviroment	: Filtir and compresure air
Operating temperature	: -20 / +70°C
Operating pressure min.	: 0.1 Mpa-Single action:0.3 Mpa
Operating pressure max.	: 1.0 Mpa
Applicable speed	: 500 mm/s
Lubrication	: No required
Stroke error	: ±0.3 mm
Action type	: Double action
Rod	: CK-45 hard chrome plated
Pipe	: ALMGSG05
Seals (Leak-proof)	: Polyurethane+ NBR
Magnet switch	: T-32R

CHANGEABLE PROPERTIES

Special cylinder for extremly hot environment
Single acting (Spring returned) cylinder
Stroke adjustment
Chanceable rod dimensions
Stainless rod possible

CYLINDER MODELS

TIS	: VDMA cylinder
TCITS	: Double rod VDMA cylinder
TTITS	: Tandem VDMA cylinder
TÖITS	: Special VDMA cylinder

STANDARD PIPE DIAMETER

Ø32	Ø50	Ø80
Ø40	Ø63	Ø100

STANDARD STROKES

50	100	160	200	250
----	-----	-----	-----	-----

ISO 6431

VDMA SİLİNDİR / VDMA CYLINDER

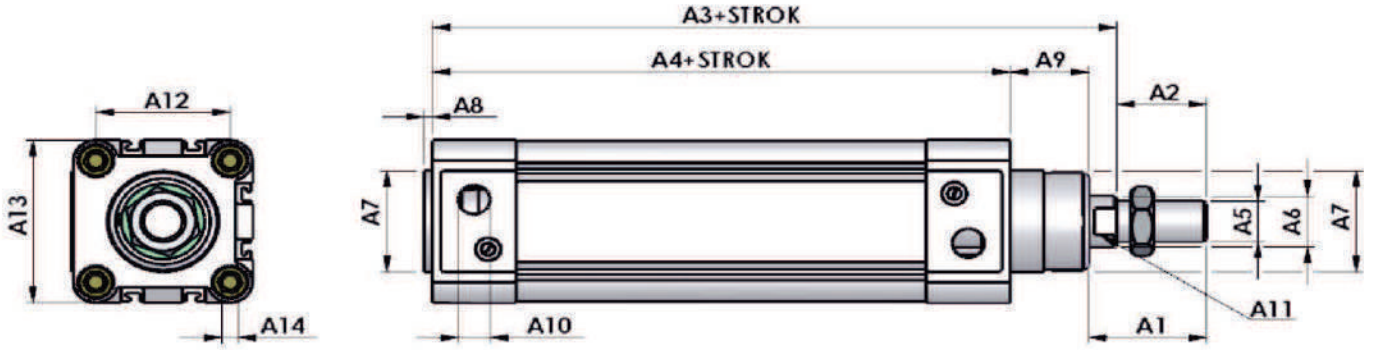

ÇİFT MİLLİ VDMA SİLİNDİR / DOUBLE ROD VDMA CYLINDER

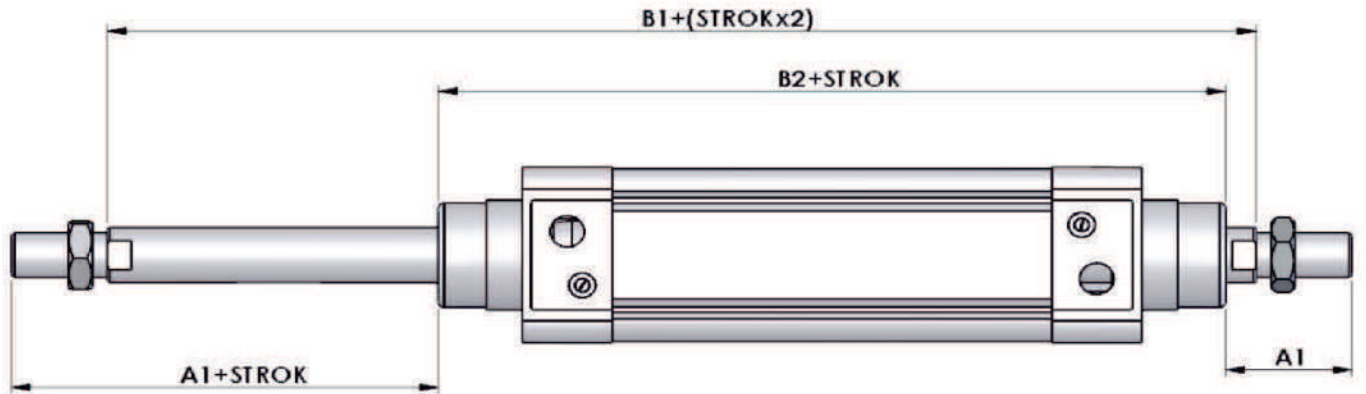

Ø	A1	A2	A3	A4	A5	A6	A7	A8	A9	A10	A11	A12	A13	A14	B1	B2
32	30	22	120	94	M10X1,25	12	30	4	18	1/8	10	32.5	45	M6	146	130
40	34	24	137	105	M12X1,25	16	35	4	22	1/4	14	38	53	M6	168	148
50	42	32	144	106	M16X1,5	20	40	4	28	1/4	17	46.5	63	M8	181	161
63	42	32	159	121	M16X1,5	20	44	4	28	3/8	17	56.5	74	M8	197	177
80	58	44	179	130	M20X1,5	25	45	5	34	3/8	22	72	82	M10	228	200
100	58	44	190	138	M20X1,5	25	55	6	38	1/2	22	89	109	M10	242	214
125	73	54	200	160	M27x2	32	60	7	40	1/2	27	110	145	M12	278	240