

ISO 6432

PASLANMAZ KALEM SİLİNDİR GRUBU / STAINLESS STEEL MICRO CYLINDER GROUP

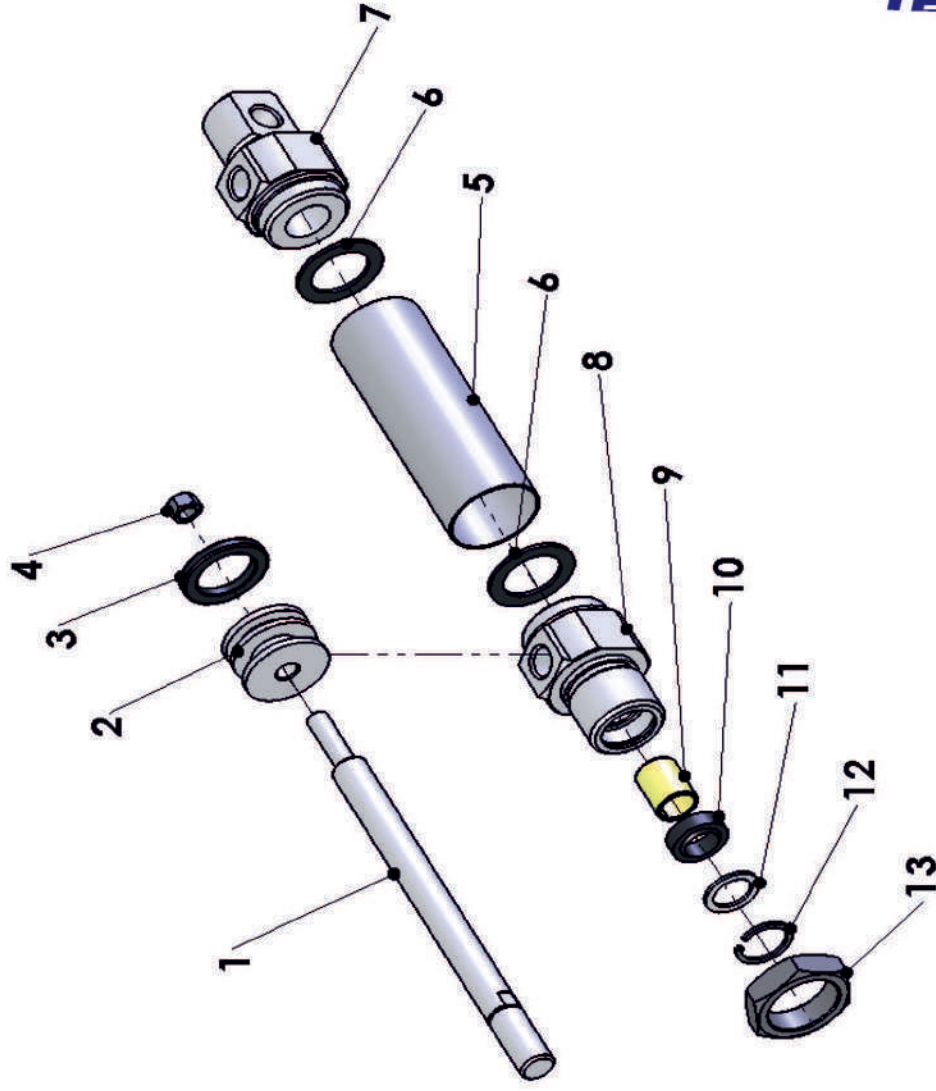

Numara NR.	Parça Adı Name of the Parts	Malzemesi Material
1	Piston Mili Piston Rod	CK 45 Sert krom kaplı CK 45 hard chrome plated
2	Keçe Yatağı Seal Bear	Alüminyum Aluminium
3	Piston Keçesi Piston Seal	NBR
4	Fiberli Somun Fiber Nut	Q St 36/2
5	Silindir Boru Cylinder Tube	Paslanmaz Çelik Stainless Steel
6	Çarpma Diski Strike Disk	NBR
7	Arka Kafa Back Cover	Alüminyum Aluminium
8	Ön Kafa Head Cover	Alüminyum Aluminium
9	Sinter Burç Sinter Bushing	Sinter Bronz Sinter Bronze
10	Boğaz Keçesi Combi Seal	NBR
11	Boğaz Keçesi Pulu Rod Seal Washer	Alüminyum Aluminium
12	Segman	Yay Çeliği Spring Steel
13	Kafa Somunu Head Nut	Çelik Steel

ISO 6432

PASLANMAZ KALEM SİLİNDİR GRUBU STAINLESS STEEL MICRO CYLINDER GROUP

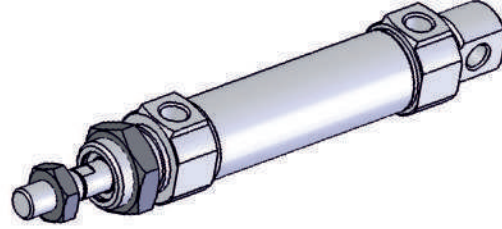

TEKMAK KALEM SİLİNDİR
TEKMAK MANYETİK KALEM SİLİNDİR
TEKMAK YASTIKLI KALEM SİLİNDİR
TEKMAK YASTIKLI MANYETİK KALEM SİLİNDİR

Ø10--Ø40 (TKS)
Ø10--Ø40 (TMKS)
Ø16---Ø40 (TYKS)
Ø16---Ø40 (TYMKS)

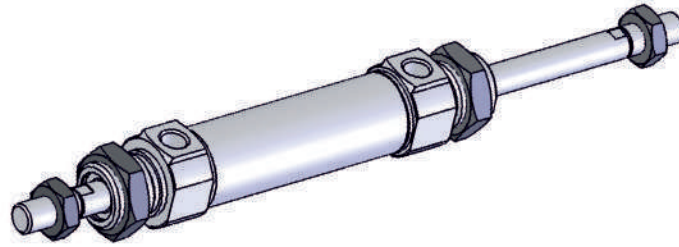

TEKMAK ÇİFT MİLLİ KALEM SİLİNDİR
TEKMAK ÇİFT MİLLİ MANYETİK KALEM SİLİNDİR
TEKMAK ÇİFT MİLLİ YASTIKLI KALEM SİLİNDİR
TEKMAK ÇİFT MİLLİ YASTIKLI MANYETİK KALEM SİLİNDİR

Ø10--Ø40 (TCKS)
Ø10--Ø40 (TCMKS)
Ø16---Ø40 (TCYKS)
Ø16---Ø40 (TCYMKS)

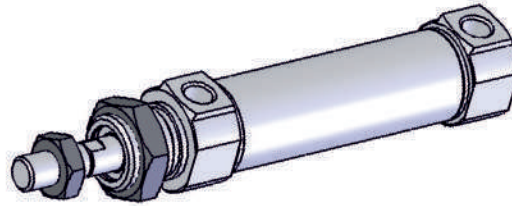

TEKMAK KISA KALEM SİLİNDİR
TEKMAK MANYETİK KISA KALEM SİLİNDİR
TEKMAK YASTIKLI KISA KALEM SİLİNDİR
TEKMAK YASTIKLI MANYETİK KISA KALEM SİLİNDİR

Ø10--Ø40 (TKKS)
Ø10--Ø40 (TMKKS)
Ø16--Ø40 (TYKKS)
Ø16--Ø40 (TYMKKS)

Sipariş nasıl verilir ? / How to Order ?

Model Silindir Çapı Strok / Model Cylinder Diameter Strok

TKS 025 100 ÇB

TKS - 025 - 100 - ÇB

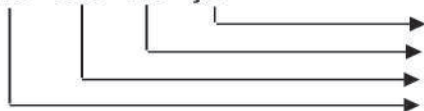

Yardımcı ekipman / Auxiliary equipment
Strok / Stroke
Silindir çapı / Cylinder diameter
Model / Model

ISO 6431

TEKNİK ÖZELLİKLER

Çalışma Ortamı	: Filtrelenmiş sıkıştırılmış hava
Çalışma sıcaklığı	: -20 / +70°C
Çalışma basıncı min.	: 0.1 Mpa-Tek etkili:0.3 Mpa
Çalışma basıncı max.	: 1.2 Mpa
Uygulanabilir hız	: 500 mm/s
Yağlama	: Şarlandırıcı yağı
Strok hatası	: ±0.3 mm
Hareket tipi	: Çift etkili
Mil	: CK-45 sert krom kaplı (10 luk silindir mili paslanmazdır.)
Boru	: Paslanmaz çelik
Sızdırmazlık	: Poliüreten+NBR
Manyetik sivic	: SDA 25

İSTEĞE BAĞLI ÖZELLİKLER

Tek etkili (yay dönüşlü)
Strok ayarlı
Mil ölçüsü değişebilir
Silindir mili paslanmaz olarak üretilebilir

SİLİNDİR MODELLERİ

TKS	: Kalem silindir
TCKS	: Çift milli kalem silindir
TCMKS	: Çift milli manyetik kalem silindir
TMKS	: Manyetik kalem silindir
TYKS	: Yastıklı Kalem silindir
TCYKS	: Çift milli Yastıklı Kalem silindir
TÖKS	: Özel kalem silindir

STANDART BORU ÇAPLARI

Ø10	Ø16	Ø25	Ø40
Ø12	Ø20	Ø32	

STANDART STROKLAR

10	25	50	100	160
----	----	----	-----	-----

TECNICAL PROPERTIES

Operating enviroment	: Filtter and compresure air
Operating temperature	: -20 / +70°C
Operating pressure min.	: 0.1 Mpa-Single action:0.3 Mpa
Operating pressure max.	: 1.2 Mpa
Applicable speed	: 500 mm/s
Lubrication	: 10 number naturel FRL oil
Stroke error	: ±0.3 mm
Action type	: Double action
Rod	: CK-45 hard chrome plated (Only Ø10 rod is stainles steel.)
Pipe	: Stainless Steel
Seals (Leak-proof)	: Polyurethane+ NBR
Magnet switch	: SDA 25

CHANGEABLE PROPERTIES

Single acting (Spring returned) cylinder
Setting stroke cylinder
Chanceable rod dimensions
Stainless rod possibility

CYLINDER MODELS

TKS	: Micro cylinder
TCKS	: Double rod micro cylinder
TCMKS	: Double rod magnet micro cylinder
TMKS	: Magnet micro cylinder
TYKS	: Cushion Micro cylinder
TCYKS	: Double rod Cushion micro cylinder
TÖKS	: Special micro cylinder

STANDARD PIPE DIAMETER

Ø10	Ø16	Ø25	Ø40
Ø12	Ø20	Ø32	

STANDARD STROKES

10	25	50	100	160
----	----	----	-----	-----

ISO 6432

KALEM SİLİNDİR / MICRO CYLINDER

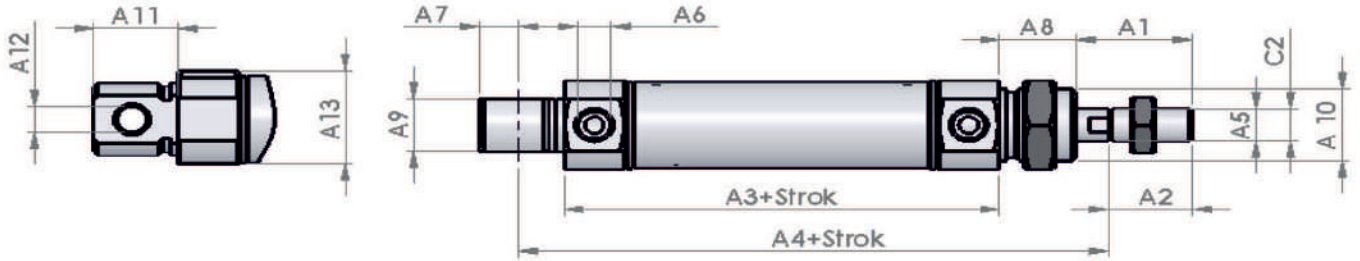

ÇİFT MİLLİ KALEM SİLİNDİR / DOUBLE ROD MICRO CYLINDER

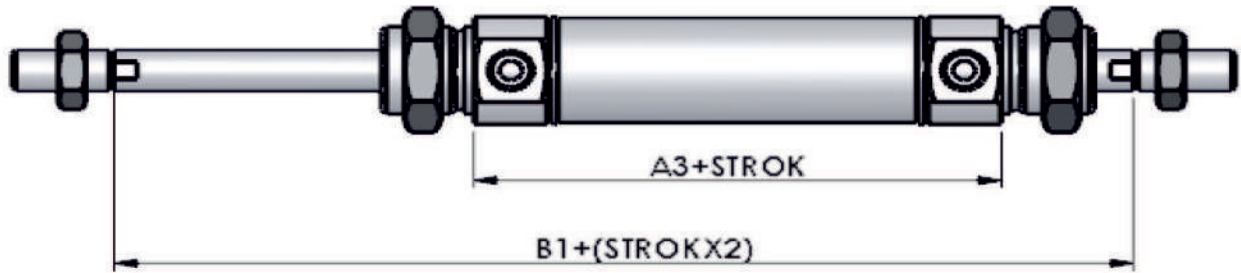

KISA KALEM SİLİNDİR / SHORTE MICRO CYLINDER

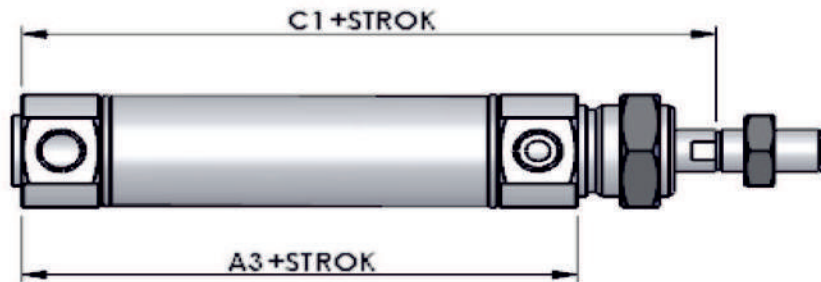

Ø	A1	A2	A3	A4	A5	A6	A7	A8	A9	A10	A11	A12	A13	B1	C1
10	18	12	45	62	M4	M5	11	11	8	M12x1,25	11	4	15	79	62
12	22	16	51	75	M6	M5	14	16	12	M16x1.5	16	6	20	95	73
16	22	16	58	82	M6	M5	14	16	12	M16x1.5	16	6	20	102	80
20	26	20	59	95	M8	1/8	10	18	16	M22x1.5	22	8	28.5	107	83
25	30	22	64	104	M10X1,25	1/8	10	20	16	M22x1.5	22	8	28.5	120	92
32	30	23	72	115	M10X1,25	1/8	12	20	20	M27x2	27	10	36,5	128	100
40	31	23	72	115	M14X1,5	1/8	12	20	20	M33x2	27	10	43,5	128	100

NOT= YASTIKLI VEYA MANYETİK OLDUĞUNDA ÖLÇÜLERDE DEĞİŞİKLİK OLMAZ.
NOTE= SIZES DO NOT CHANGE IF IT HAS CUSHION OR MAGNETIC.

ISO 6432

ÇATAL BAĞLANTI (ÇB) / ROD CLEVIS (RC)

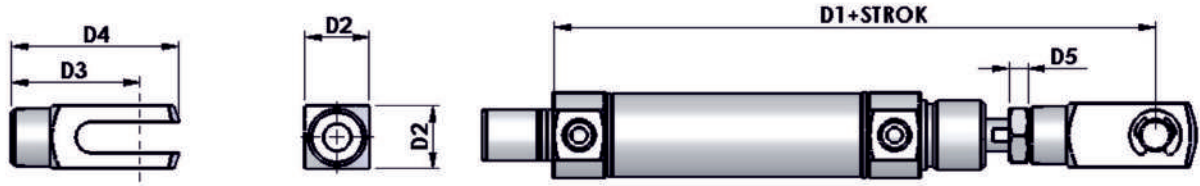

EKLEM YER BAĞLANTI (EYB) / SWIVEL FLANGE WITH FOOT MOUNTING (MF)

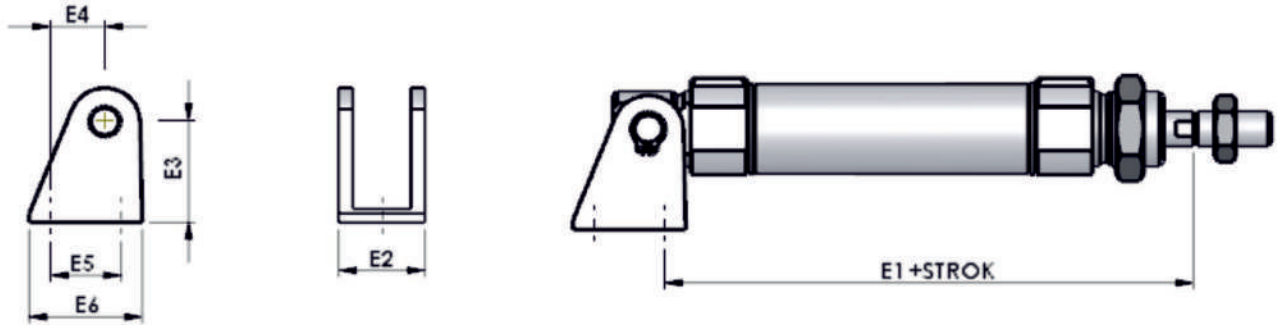

FLANŞ BAĞLANTI (FB) / FLANGE MOUNTING (MF)

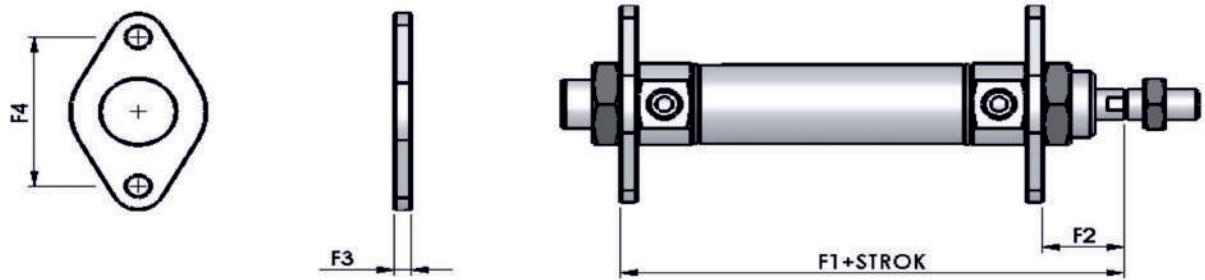

AYAK BAĞLANTI (AB) / FOOT MOUNTING (FM)

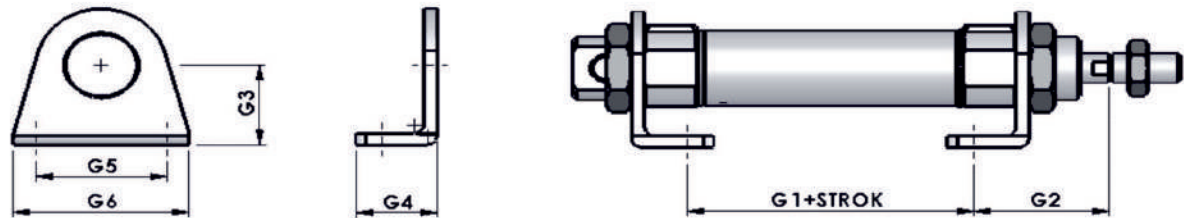

Ø	D1	D2	D3	D4	D5	E1	E2	E3	E4	E5	E6	F1	F2	F3	F4	G1	G2	G3	G4	G5	G6
12	97	12.7	24	31	5	73	18	27	13	15	25	77	18	4	40	31	32	20	20	32	42
16	104	12.7	24	31	5	80	18	27	13	15	25	84	18	4	40	38	32	20	20	32	42
20	115	16	32	42	6	91	24	30	16	20	32	88	19	5	50	35	36	25	25	40	54
25	132	20	40	52	6	100	24	30	16	20	32	97	23	5	50	40	40	25	25	40	54
32	145	20	40	52	6	110	28	40	20	25	40	104,5	23,5	5	60	41	43,5	35	30	40	55
40	155	24	48	62	7	110	28	40	20	25	40	104,5	23,5	5	80	41	43,5	40	30	50	75